

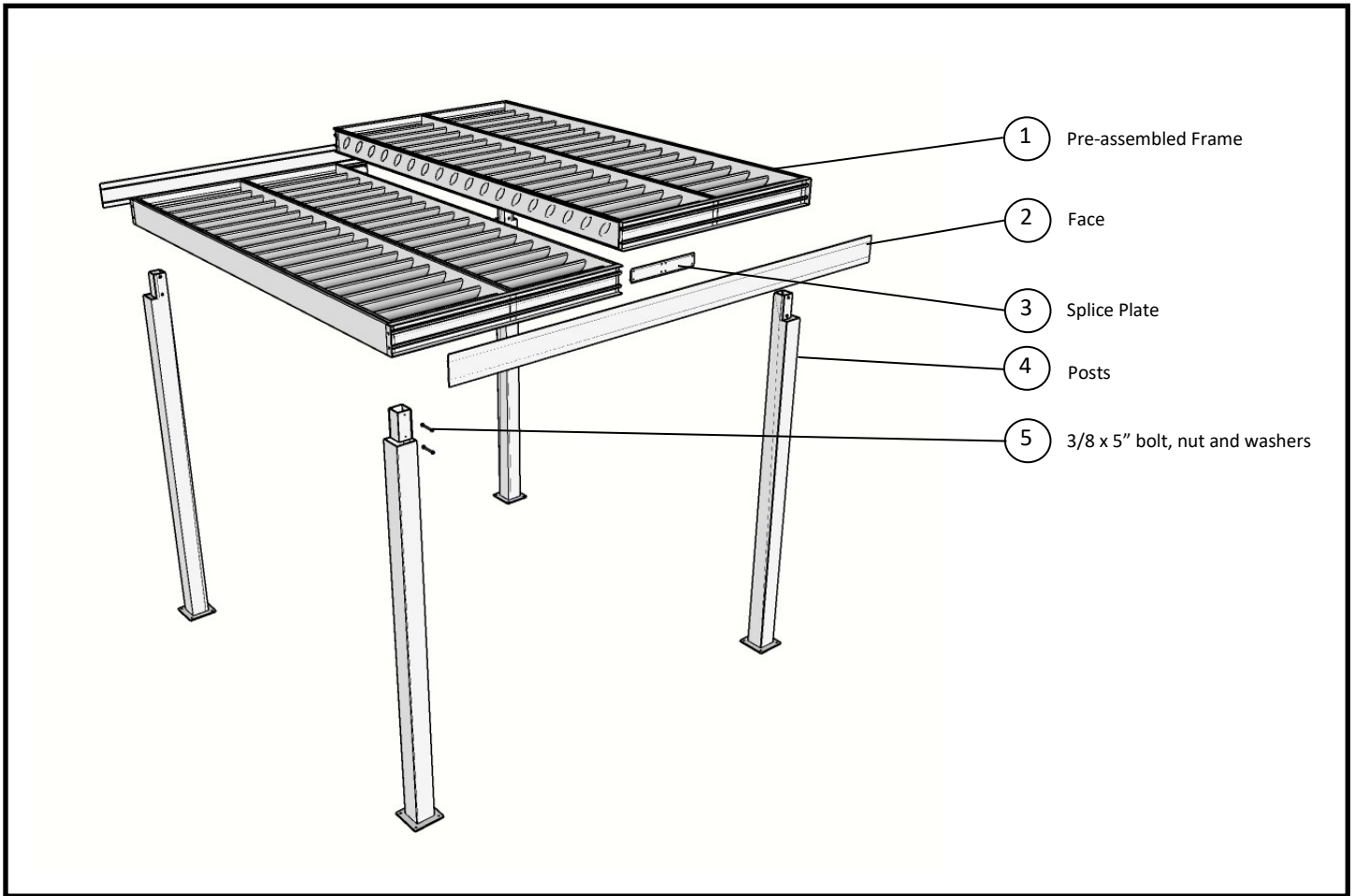

Installation Instructions

For the

Tuscany System, Flush Post style



These instructions are written with the assumption that the footers are already in place and the anchors set to conform with the bolt patterns in the base plates on the posts. This should be coordinated with the GC early in the project timeline to ensure this. Also, it is common practice to set the footer below the finish surface to allow a quik-crete/grout mixture to fill over the anchors and base plate for a finished look.

The illustrations show 6" airfoil infill panels. There are many optional infill panels available. The system your installing may have different infill panels. This should not change the install procedures shown here.

1. Upon delivery, inspect the product for any damages that may have occurred during transit. Open the field kit crate, review the drawing package and check the field kit quantities and the packing list.
2. Refer to project specific drawing package for intended method of installation. - Begin installation by setting the Posts (#4) onto the anchors at top of the footers. Make sure you have nuts below and above the base plate to allow adjustment. (see fig 2)
3. Once all post are in place, make sure they are plumb and the tops are level with each other. This is done by adjusting the nuts on the footer anchor bolts. (see fig 3)

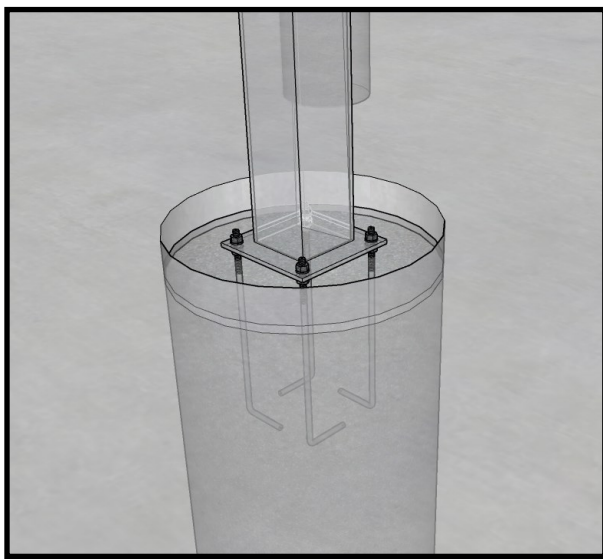

Fig 1

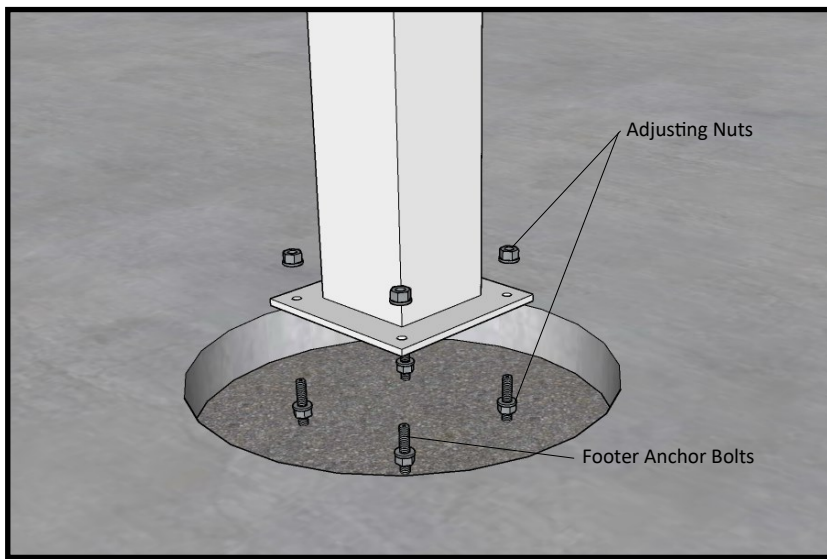

Fig 2

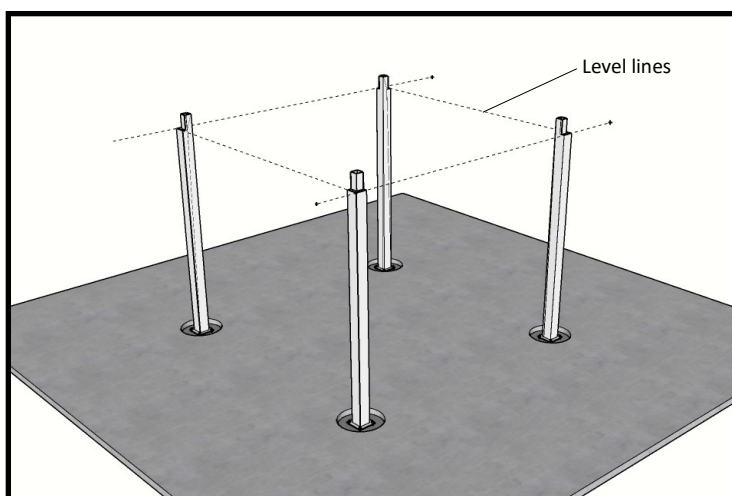

Fig 3

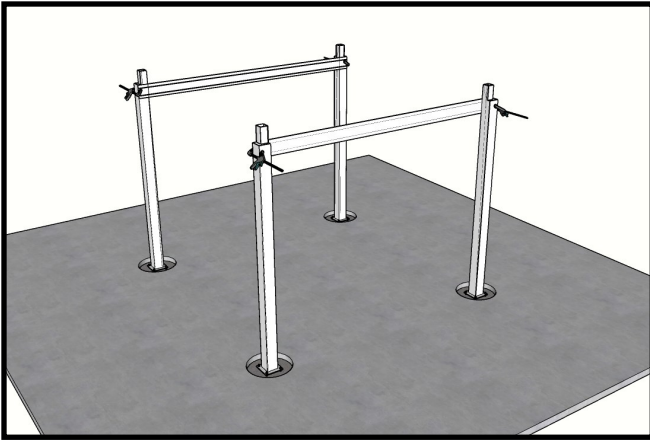

Fig 4

5. Set the Frames (#1) in place as shown in the drawing package. Make sure the Frame corners set over post notches as shown in fig 5a. To snap the frames together, use the same soft padded clamps. Make sure the frames are aligned by positioning the Splice Plates in the frame slots and slid to one side of the seam. (see fig 7)

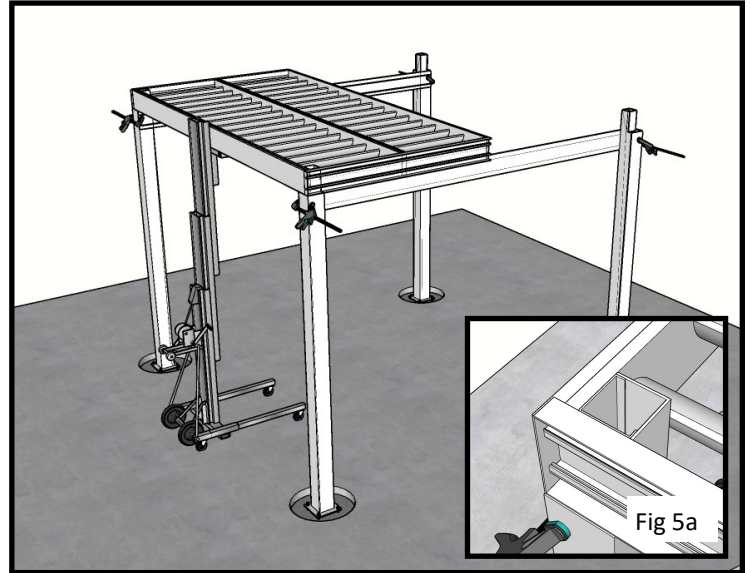

Fig 5

6. Once you have all of the frames together and positioned where they go, slide the splice plates over centered on the frame seam. (see fig 8) Secure with a dab of caulk.

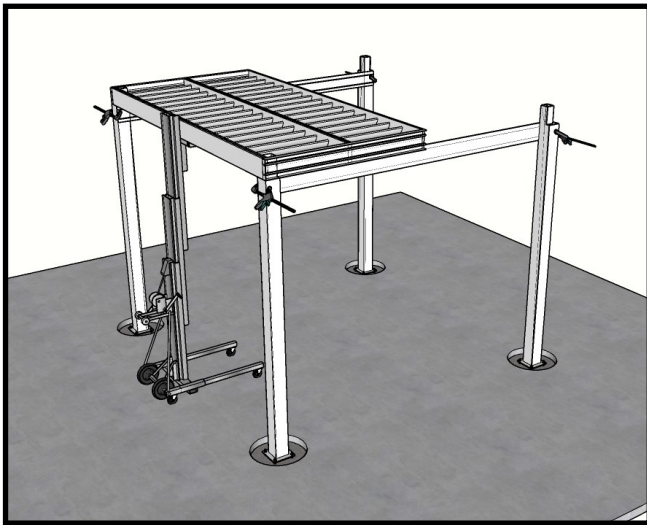

Fig 6

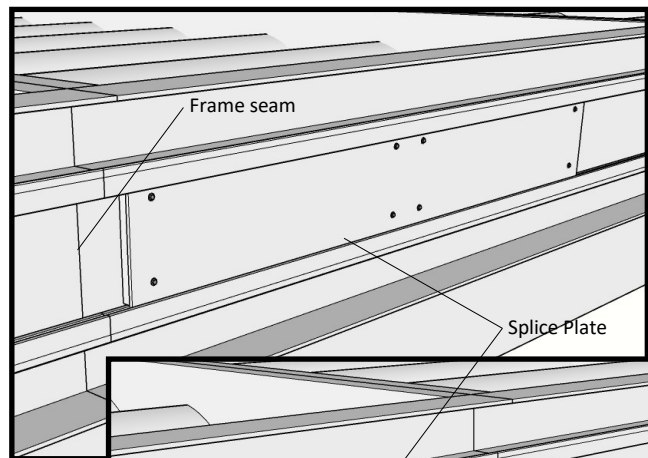

Fig 7

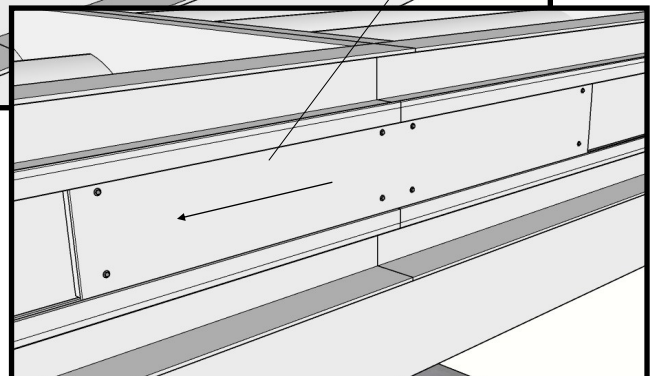

Fig 8

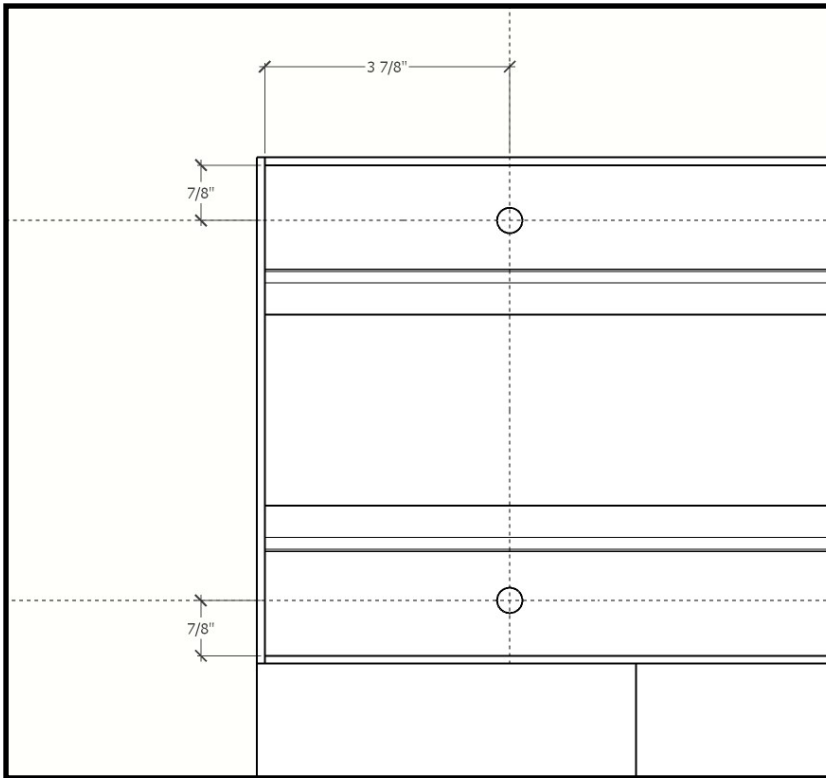

Fig 9

7. At each post, mark hole locations on the inside of the frame channel as shown in fig 9.
8. Drill two 7/16" dia holes through to the back side of the posts. (see fig 10)
9. Install the 3/8" x 5" bolts provided. Use the flat washers, lock washer and nut. Tighten to secure. Two bolts each post. (see fig 11)
10. Once installed, remove the temporary beams.

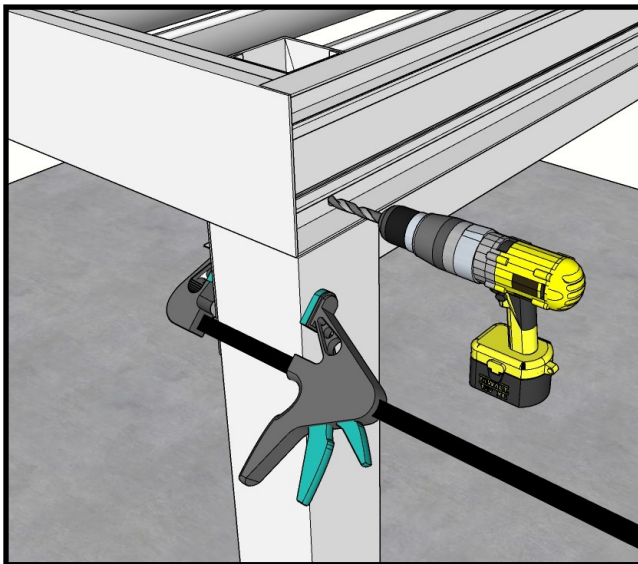

Fig 10

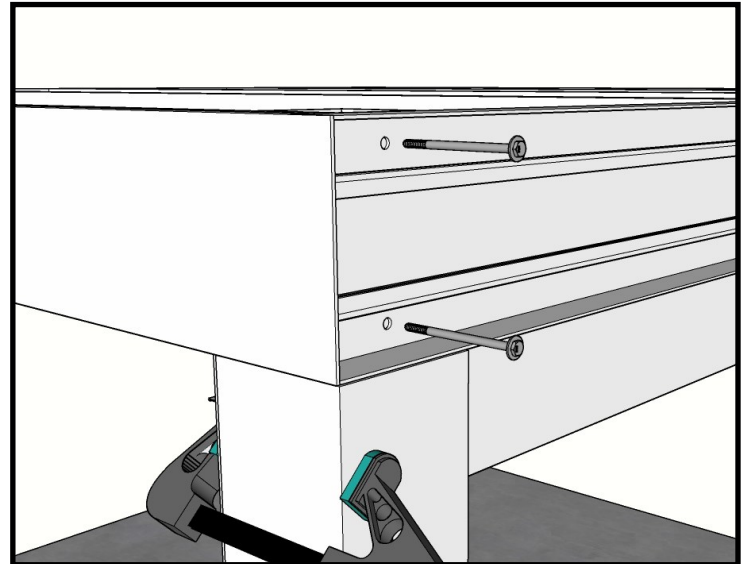

Fig 11

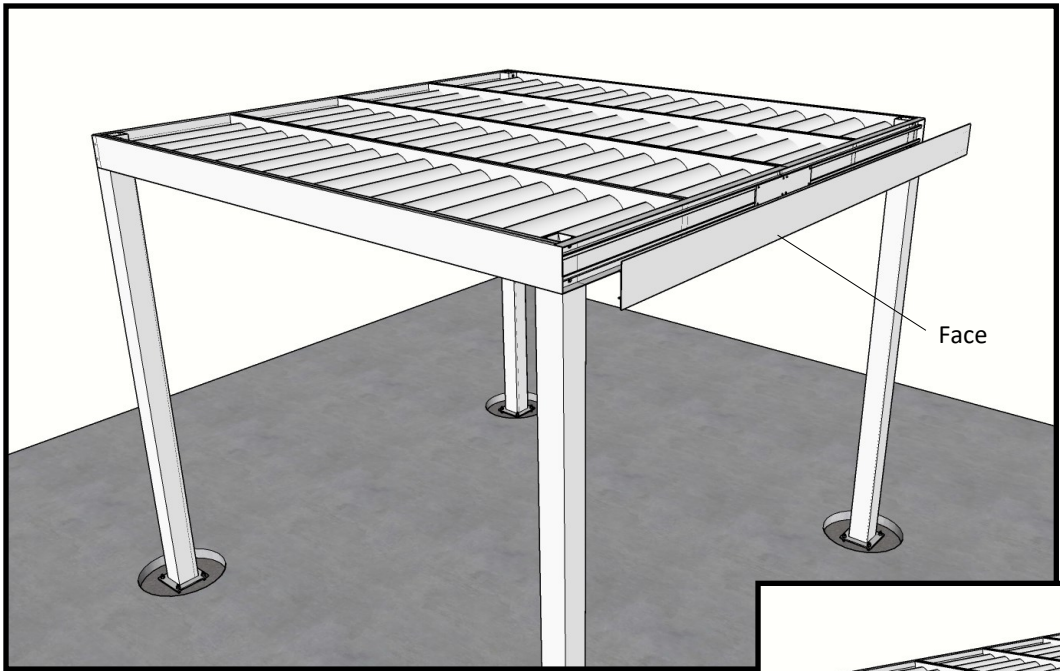

Fig 12

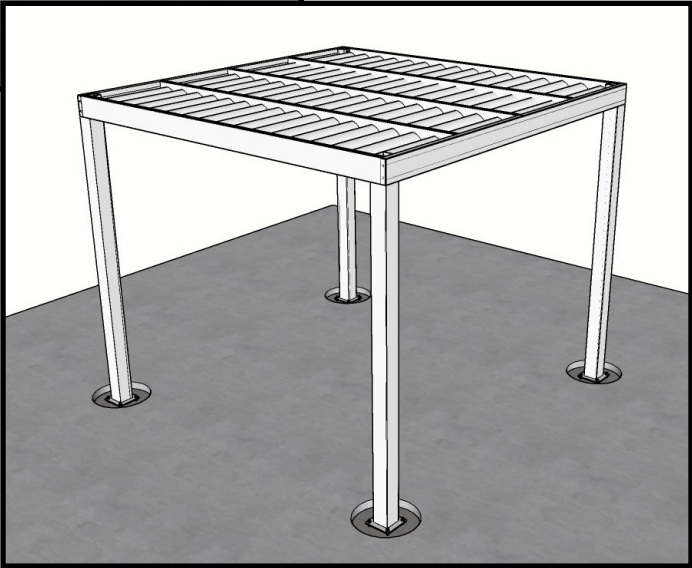

Fig 13

- 11. Install the Face (#2). The face simply snaps on. You may need to use a rubber mallet in some spots. Make sure you protect the paint finish. Cut to length if necessary. When cutting powder coated extrusions, protect the paint finish by using masking tape and then sealing the raw cut.
- 12. Touch up all exposed hardware screws as needed with supplied touch up paint.
- 13. Wipe down all surfaces removing dirt, smudges and hand prints.